

SANTA MONICA ELEMENTARY AND MIDDLE SCHOOL HISTORIC RESOURCES REPORTS

Carey Upton, Chief Operations Officer
Executive Summary for Board of Education
January 28, 2022



Historical Resources

Summary of Findings

HRG and ARG findings determined that other than the Main Building at Franklin (B) no individual buildings would be eligible as potential Historic Resources under Federal, State or Local criteria.

HRG and ARG findings have identified historic districts potentially eligible for listing in the California Register and for designation at the local level at several campuses.

Historical Resources

Historic Districts

School campuses and other institutional resources often encompass multiple buildings and site features with common characteristics. In these instances, it is appropriate to evaluate campuses as historic districts, which are defined and described in NRB 15 as follows:

A district possesses a significant concentration, linkage, or continuity of sites, buildings, structures, or objects united historically or aesthetically by plan or physical development. A district derives its importance from being a unified entity, even though it is often composed of a wide variety of resources. The identity of a district results from the interrelationship of its resources, which can convey a visual sense of the overall historic environment or be an arrangement of historically or functionally related properties . . .

Historical Resources

Historic Districts

...A district can comprise both features that lack individual distinction and individually distinctive features that serve as focal points. It may even be considered eligible if all of the components lack individual distinction, provided that the grouping achieves significance as a whole within its historic context.

By contrast, schools that developed over an extended period – which often include buildings and other resources that embody various architectural styles and are associated with different eras of growth – are generally not evaluated as districts due to a dearth of visual continuity.

Historical Resources

Historic Districts

K-12 Schools are not typically evaluated as Historic Districts.

We are doing further research, but to this point LAUSD is the only other California school district we have found that has designated a K-12 campus as a Historic District.

Historical Resources

Historic Districts

As part of the CEQA process, there will be analysis of the campus plans and the impact on the integrity of the historic district. In specific cases, contributing members can be removed or altered without negatively impacting the integrity of the historic district. This will be analyzed as part of the CEQA process.

ARG and HRG will participate in the CEQA analysis and consult with the campus architects on any alterations or adaptive use of potential historic resources.

McKinley ES—Historical Resources

Summary of Findings

HRG has identified a potential historic district at McKinley Elementary School that is eligible for listing in the California Register and for designation at the local level. The potential historic district consists of two (2) contributing buildings, two (2) site features, and two (2) additional features with a period of significance from 1923 to 1937. Contributors to the potential historic district are as follows:

McKinley ES—Historical Resources

Potential Historic Resources – Historic District

Buildings

- Building B, 1923
- Building C, 1923

(expanded 1929-30; rehabilitated 1935-37; modernization 1973, modernization Building C only 1999)

Site Features

- Santa Monica Boulevard Quad, 1923
- Main Courtyard, 1923

Additional Features

- "Storybook Land" Sculpture, 1936
- WPA Bronze Plaque, 1937

McKinley ES—Historical Resources Summary of Findings

7

Figure 3. Existing Site Plan

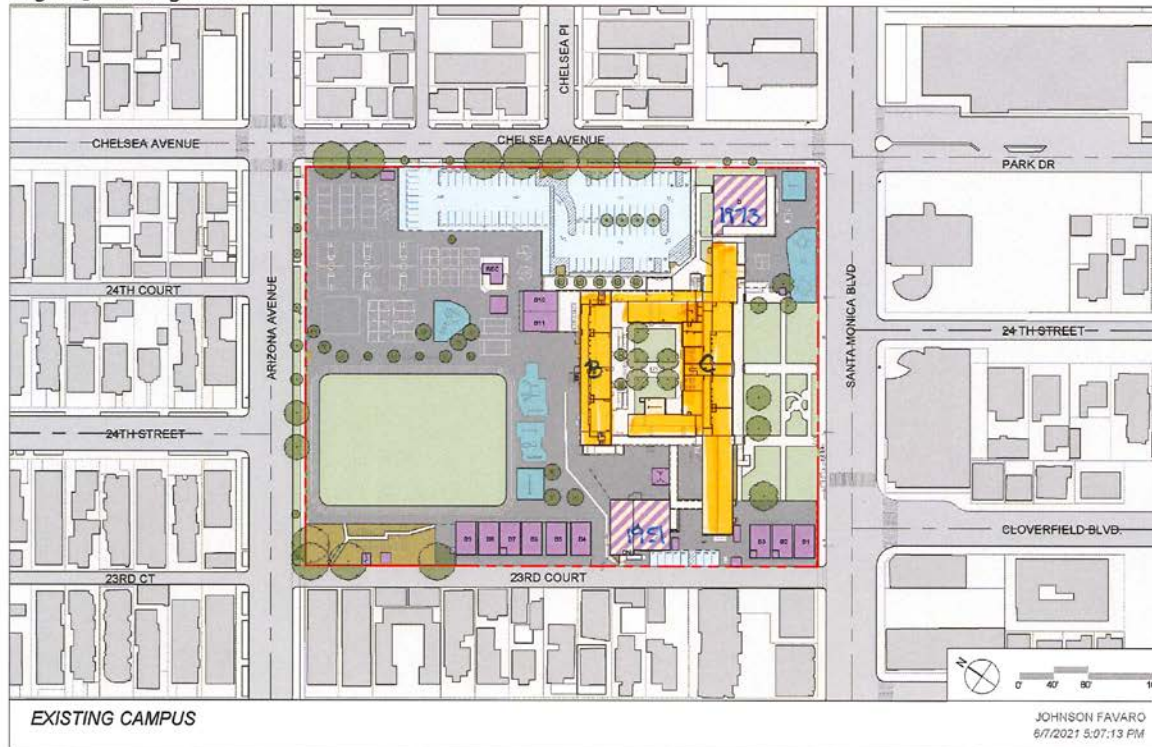

McKinley Elementary School Historic Resources Inventory Report

HISTORIC RESOURCES GROUP

WEST COLONNAD
ADDED 1951
EAST COLONNAD
1929 or 1935?

Buildings B+C 1923 Allison+Allison

1929-30 EXPANDED BY Allison+
Allison

1935-37 REHAB BY PARKINSON +
PARKINSON

1973 MOD BY POWELL, MONTAGNE
RICHARDS + COSTAN

1999 MOD COUNTY SUPERVISOR

Franklin ES—Historical Resources

Summary of Findings

Franklin Elementary School, as a whole, does not appear eligible for federal, state, or local listing. The buildings and site features comprising the campus – which were erected at various periods between the 1930s and 1950s – do not collectively express the principles or values associated with any one period of school development or District history, namely the Depression and early postwar periods. The campus's extant buildings and site features are a somewhat disparate and eclectic collection of campus planning, design, and architecture.

Franklin ES—Historical Resources

Summary of Findings

Building B – which is the original campus building, and the historical anchor of the Franklin campus – appears to be individually eligible for listing in the California Register of Historical Resources under Criteria 1 and 3, and for local (City of Santa Monica) listing under Criteria 1, 4, and 5. This building is associated with important patterns of history related to Santa Monica’s civic and institutional development, and is also a singularly significant work of master architects Marsh, Smith and Powell. The evaluation also includes the lawn at the front (north) of the site.

Franklin ES—Existing Campus Plan



SATELLITE CAMPUS IMPROVEMENTS

Rogers ES—Historical Resources

Summary of Findings

HRG has identified a potential historic district at Will Rogers Learning Community that is eligible for listing in the California Register and for designation at the local level. The potential historic district consists of thirteen (13) contributing buildings, three (3) site features, and one (1) additional feature with a period of significance from 1948 to 1950. Contributors to the potential historic district are as follows:

Rogers ES—Historical Resources

Summary of Findings

Buildings

A (1948); B/C (1948); D 91948); E (1948); F (1948); G (1948); H (1948); J (1948); K (1950); L (1948); M (1950); N (1950); and P (1950)

Site Features

Courtyards (1948); 14th Street Quad (1948); and Stone Planters (c. 1948)

Additional Features

“Will Rogers Elementary School” Sign (c.1948)

Rogers ES—Historical Resources

Summary of Findings



Grant ES—Historical Resources

Summary of Findings

Grant Elementary School appears eligible for listing in the California Register of Historical Resources under Criteria 1 and 3, and for local (City of Santa Monica) listing under Criteria 1, 4, and 5 as a historic district comprising multiple buildings and associated site/landscape features.

Potential significance is derived from the synergy of contributing buildings and site features; no building or site feature on the campus appears to be individually eligible when evaluated independent of the larger historic district.

Grant ES—Historical Resources

Summary of Findings

The following are considered to be contributing elements of the district: Buildings B, C, D, E, G, and H; the landscaped courtyard bounded by Buildings B, C, D, and G; and the paved forecourt and flagpole at the north end of the campus, as approached from Pearl Street.

Grant ES—Historical Resources

Summary of Findings

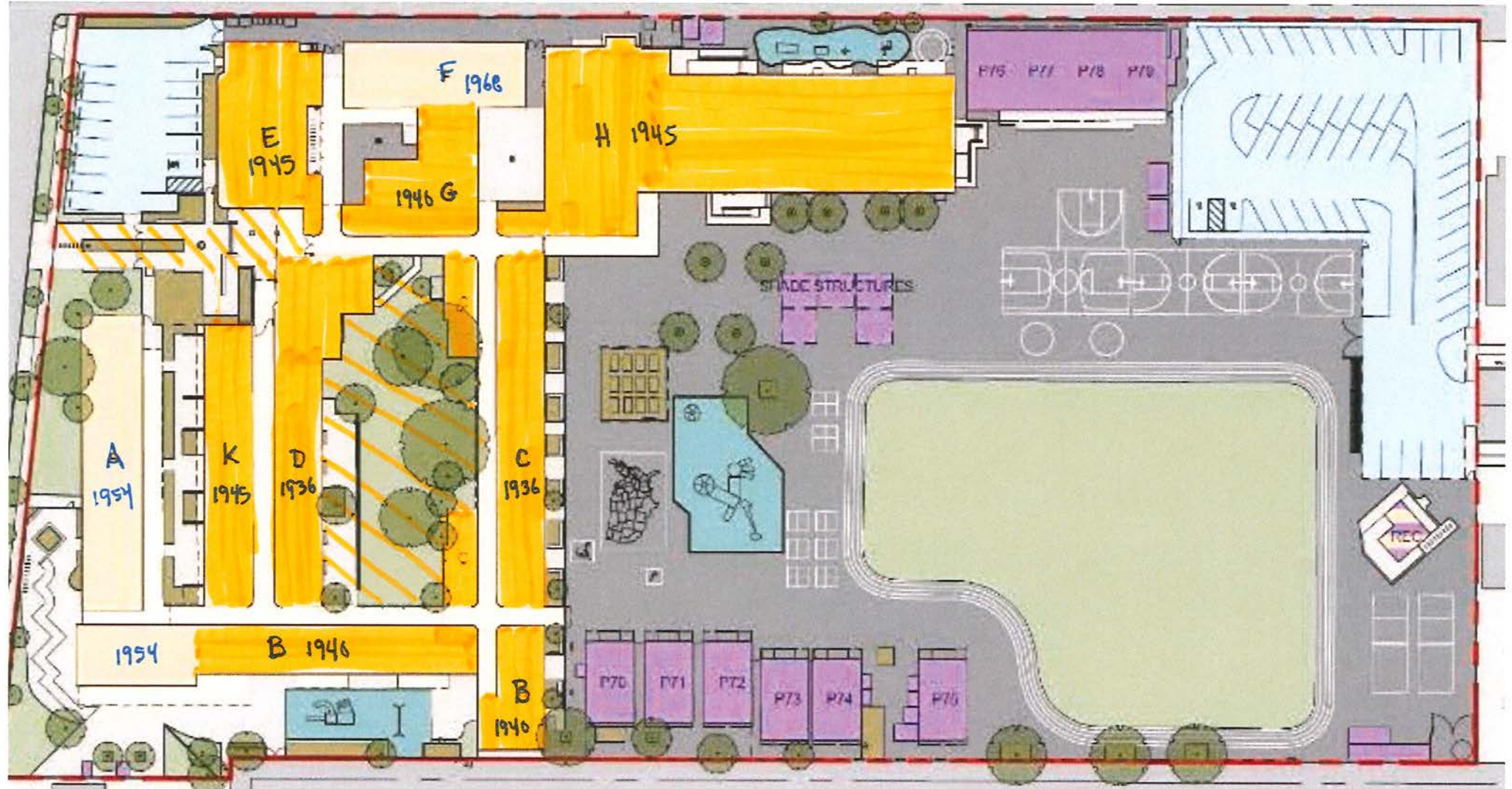

John Adams MS—Historical Resources

Summary of Findings

HRG has identified a potential historic district at John Adams Middle School that is eligible for listing in the California Register and for designation at the local level. The potential historic district consists of eight (8) contributing buildings, five (5) site features, and three (3) additional features with a period of significance from 1935 to 1948. Contributors to the potential historic district are as follows:

John Adams MS—Historical Resources

Summary of Findings

Buildings

N South (1935); Q (1935); T (1935); U (1935); C (1938/1945);
N North (1938); P (1938); and S (1938)

Site Features

16th Street Quad (1935); Southwest Courtyard (1935);
Northwest Courtyard (1935); Southeast Courtyard (1935);
Northeast Courtyard (1935)

Additional Features

“John Adams Middle School” Sign (1935); “Boys” Sign (1938);
and PWA Bronze Plaque (1939)

John Adams MS—Historical Resources

Summary of Findings

Buildings

N South (1935); Q (1935); T (1935); U (1935); C (1938/1945);
N North (1938); P (1938); and S (1938)

Site Features

16th Street Quad (1935); Southwest Courtyard (1935);
Northwest Courtyard (1935); Southeast Courtyard (1935);
Northeast Courtyard (1935)

Additional Features

“John Adams Middle School” Sign (1935); “Boys” Sign (1938);
and PWA Bronze Plaque (1939)

John Adams MS—Historical Resources

Summary of Findings



Roosevelt ES—Historical Resources

Summary of Findings

HRG has identified a potential historic district at Roosevelt Elementary School that is eligible for listing in the California Register and for designation at the local level. The potential historic district consists of six (6) contributing buildings, five (5) site features, and two (2) additional features with a period of significance from 1935 to 1940. Contributors to the potential historic district are as follows:

Roosevelt ES—Historical Resources

Summary of Findings

Buildings

B (1940); C (1940); E (1935); G (1935); J (1935); Portion of Building K (1935)

Site Features

Lincoln & Montana Quad (1935); South Courtyard (1935); North Courtyard (1935); Brick Flagpole Ring (1935); Brick Wall (1935)

Additional Features

“Theodore Roosevelt” Panel (c. 1935); and WPA Bronze Plaque (1940)

Roosevelt ES—Historical Resources

Summary of Findings



Lincoln MS—Historical Resources

Summary of Findings

None of the buildings or site features associated with the Lincoln Middle School campus appear to be individually eligible for designation, either because they do not individually meet eligibility criteria for designation or because they have been extensively altered and lack integrity.

Lincoln Middle School does not appear to satisfy the definition of a district. It contains buildings and other site features that were constructed at various periods over the course of the twentieth century.

Lincoln MS—Historical Resources

Summary of Findings

The campus contains buildings and features that date to its original construction in the 1920s, albeit in highly modified form; several buildings from the postwar period; and a large building that was constructed in 2013. These buildings are designed in architectural styles that were popular at their time of construction and do not bear a particularly strong visual relationship with one another. The placement of buildings also does not adhere to a cogent plan; rather, they appear to have been located at sites that could accommodate their mass. When viewed as a whole, the campus reads as an amalgamation of different parts that do not bear a particularly strong relationship with one another.